

### Grooved Cross

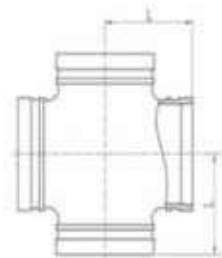

Nominal Size mm/in	Pipe OD mm/in	Dimensions		Woking Presssure Psi/Mpa	Certificate
		mm			
		L			
25	33.7	57		300	FM UL
1	1.327	57		2.07	FM UL
32	42.4	70		300	FM UL
1¼	1.669	70		2.07	FM UL
40	48.3	70		300	FM UL
1½	1.9	70		2.07	FM UL
50	60.3	83		300	FM UL
2	2.375	83		2.07	FM UL
65	73	95		300	FM UL
2½	2.875	95		2.07	FM UL
65	76.1	95		300	FM UL
2¾	3	95		2.07	FM UL
80	88.9	108		300	FM UL
3	3.5	108		2.07	FM UL
100	108.3	127		300	FM UL
4	4.25	127		2.07	FM UL
100	114.3	127		300	FM UL
4	4.5	127		2.07	FM UL
125	133	140		300	FM UL
5	5.25	140		2.07	FM UL
125	139.7	140		300	FM UL
5	5.5	140		2.07	FM UL
125	141.3	140		300	FM UL
5	5.563	140		2.07	FM UL
150	159	165		300	FM UL
6	6.25	165		2.07	FM UL
150	165.1	165		300	FM UL
6	6.5	165		2.07	FM UL
150	168.3	165		300	FM UL
6	6.625	165		2.07	FM UL
200	219.1	197		300	FM UL
8	8.625	197		2.07	FM UL
250	273	229		300	FM UL
10	10.75	229		2.07	FM UL
300	323.9	254		300	FM UL
12	12.75	254		2.07	FM UL

### Grooved Cross Standard

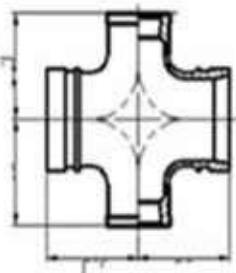

Nominal Size mm/in	Pipe OD mm/in	Dimensions		Woking Presssure Psi/Mpa	Certificate
		mm			
		L			
25	33.7	57		300	FM UL
1	1.327	57		2.07	FM UL
32	42.4	70		300	FM UL
1¼	1.669	70		2.07	FM UL
40	48.3	70		300	FM UL
1½	1.9	70		2.07	FM UL
50	60.3	83		300	FM UL
2	2.375	83		2.07	FM UL
65	73	95		300	FM UL
2½	2.875	95		2.07	FM UL
65	76.1	95		300	FM UL
2¾	3	95		2.07	FM UL
80	88.9	108		300	FM UL
3	3.5	108		2.07	FM UL
100	108.3	127		300	FM UL
4	4.25	127		2.07	FM UL
100	114.3	127		300	FM UL
4	4.5	127		2.07	FM UL
125	133	140		300	FM UL
5	5.25	140		2.07	FM UL
125	139.7	140		300	FM UL
5	5.5	140		2.07	FM UL
125	141.3	140		300	FM UL
5	5.563	140		2.07	FM UL
150	159	165		300	FM UL
6	6.25	165		2.07	FM UL
150	165.1	165		300	FM UL
6	6.5	165		2.07	FM UL
150	168.3	165		300	FM UL
6	6.625	165		2.07	FM UL
200	219.1	197		300	FM UL
8	8.625	197		2.07	FM UL
250	273	229		300	FM UL
10	10.75	229		2.07	FM UL
300	323.9	254		300	FM UL
12	12.75	254		2.07	FM UL